

PANEL DIMENSIONS ONLY

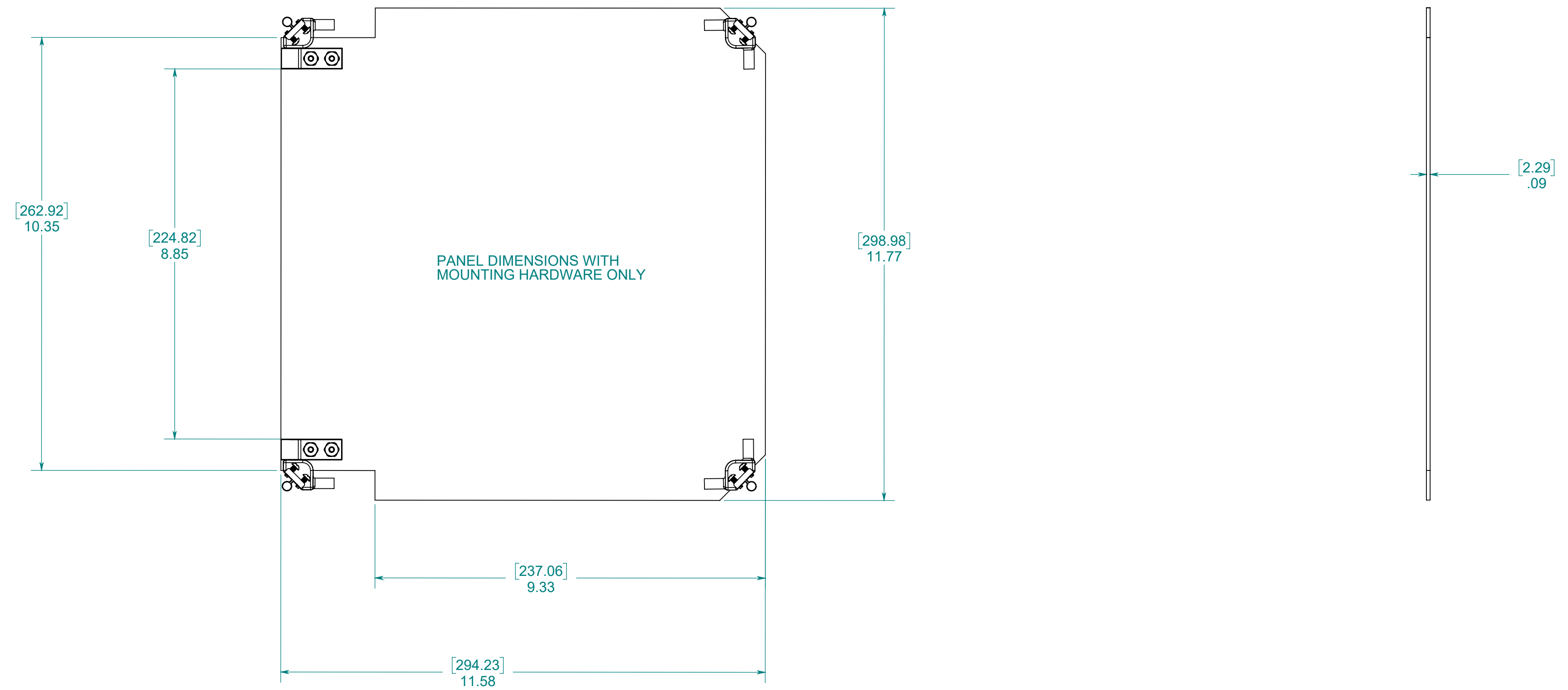

ITEM NO.	PART NUMBER	DESCRIPTION	HFP,BP,ENCLOSURE/QTY.
1	70-63238	SCREW SEMS 6-32X.375	4
2	70-440516PC	#4-40 SELF TAP SCREW	8
3	70-HFPP1212PC-1	SWING PANEL 12 X 12 ALUMINUM	1
4	70-60431	#6 TYPE A PLAIN WASHER	4
5	70-632	#6-32 HEX MACHINE SCREW NUT	4
6	WPHINGE-HFPP	POLYCARBONATE HFP HINGE	2
7	WPSLIDERI	POLY INSERTED CORNER SLIDER	4
8	55-1032516	COMBO PAN HEAD MACHINE SCREW	2
9	AMP1226	AMP Polyline	1

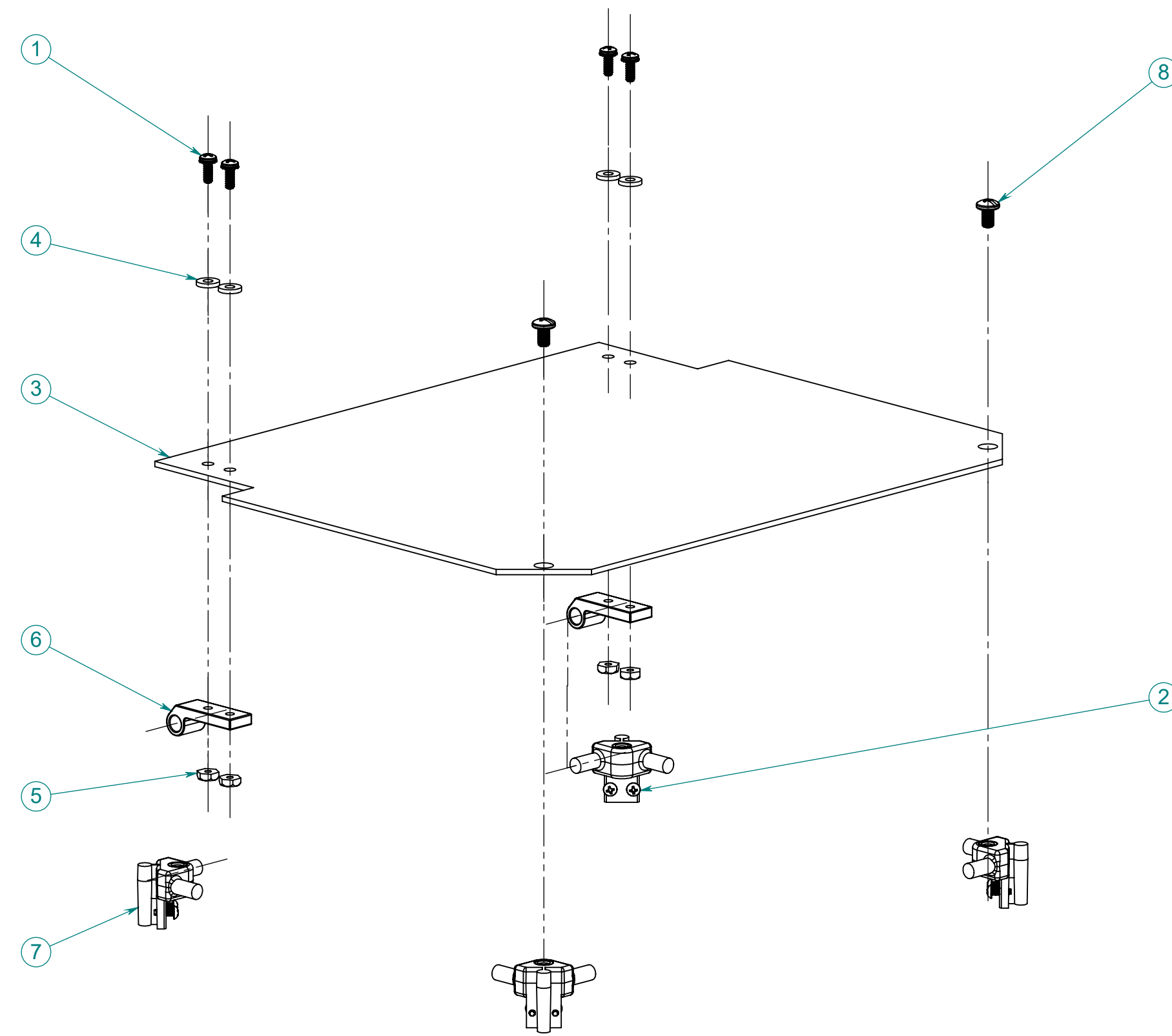
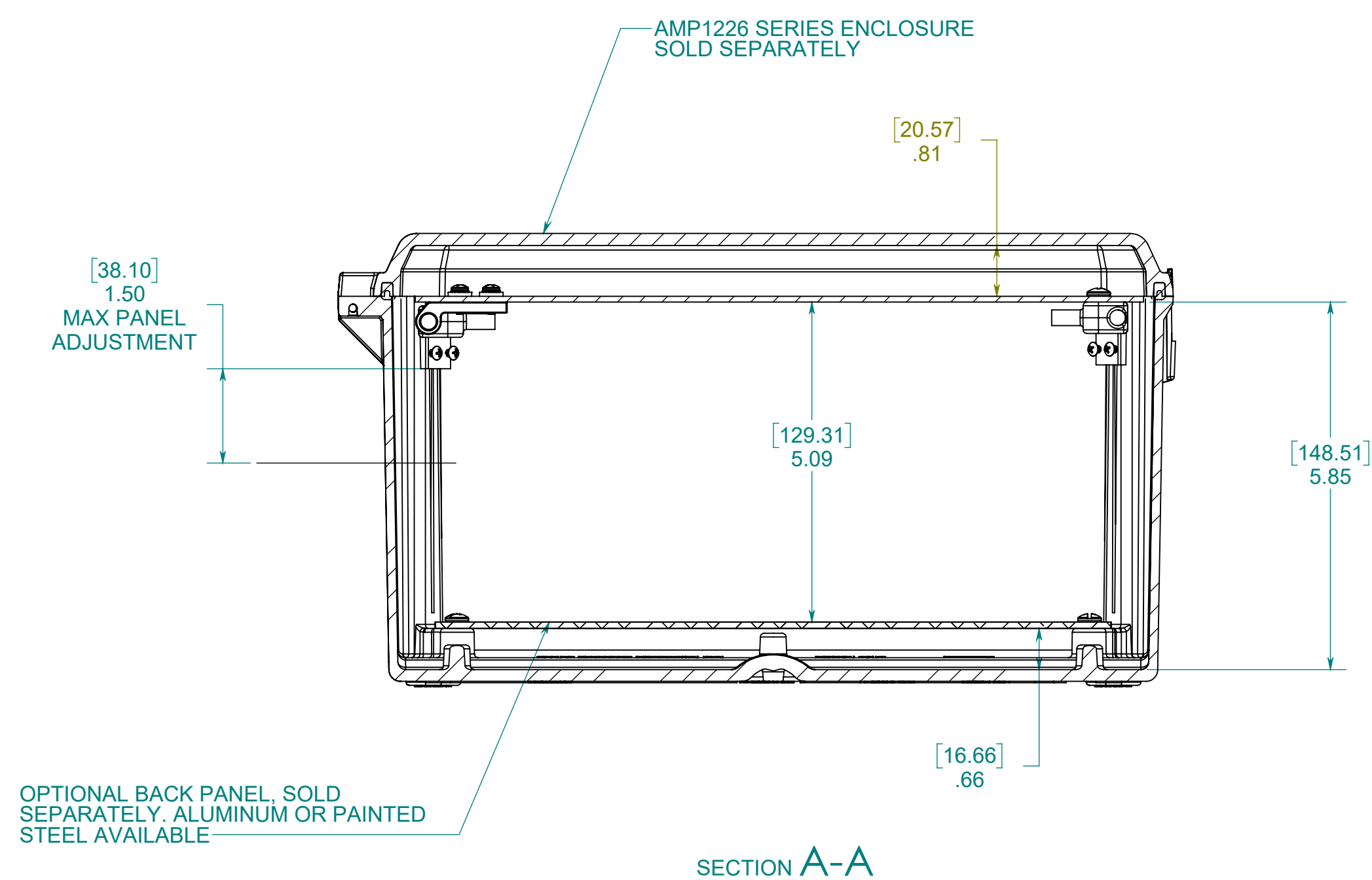

NOTE:
1. DATA SUBJECT TO CHANGE WITHOUT NOTICE

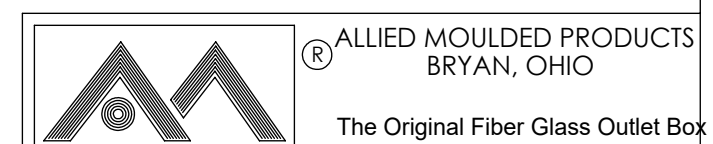

CONFIDENTIAL
THIS MATERIAL IS OWNED BY THE ALLIED MOULDED PRODUCTS COMPANY, IS DISCLOSED IN CONFIDENCE, AND IS NOT TO BE REPRODUCED OR DISTRIBUTED WITHOUT PRIOR WRITTEN PERMISSION FROM ALLIED MOULDED PRODUCTS.
© 2018 Allied Moulded Products, Inc. All Rights Reserved

Description
Access-Indus
Part No.
HFPP122